

60W LED Tube Down Light

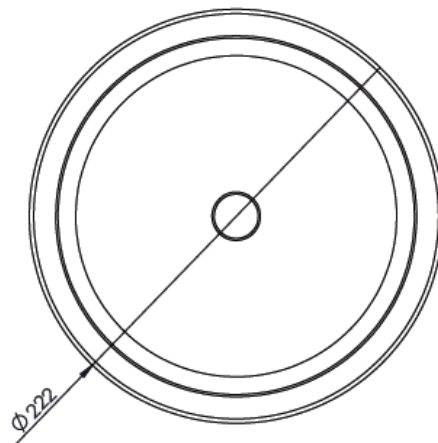

Product Dimension

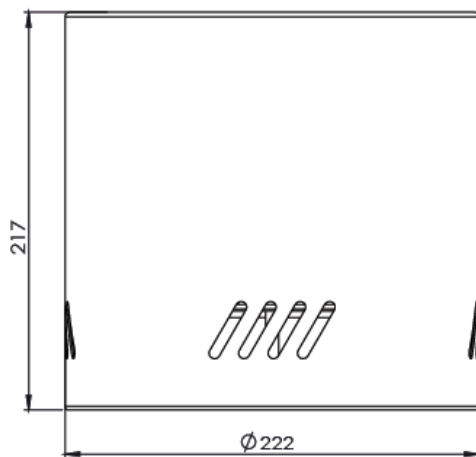

Unit: mm
Tolerance: 5mm



Specifications

Item	Symbol	Typical	Unit	Remark
Input voltage	Vin	90-264	Vac	
Input frequency	Fin	50/60	Hz	
Power consumption	Pin	60	W	
Color temperature	CW	5700	K	
	NW	4000		
	WW	3000		
Luminous flux	CW	4800	lm	
	NW	4800		
	WW	4500		
Color rendering index	CRI	75		
Beam angle		46	°	
Operating Temperature	Topr	-30~40		
Warranty		2	Years	

Scope

Item	Marketing Name	Pin	CCT
CW	CSTD60CW	60W	5700 K
NW	CSTD60NW	60W	4000 K
WW	CSTD60WW	60W	3000 K